



Panther UXP

High-resolution display for stand-alone presentation applications

Features

- 67" digital display
- UXGA (1,600 x 1,200) native resolution
- Rear-projection AP/LCD™ display technology
- Glass black screen for wide-angle viewing
- New illumination system with redundant long-life bulbs
- 26.5" depth
- Finish cabinetry and built-in casters
- Front-panel source selectors
- Panther Plus adds stereo audio capability

The Clarity Panther (PN-6730-UXP) and Panther Plus (PN-6740-UXP) are 67" rear-projection displays optimized for use as stand-alone presentation systems in corporate facilities. They combine extremely high resolution and image quality with stylish cabinetry and easy mobility to create very compelling alternatives to front-projection systems or fixed-installation displays.

Designed-in versatility makes Panther ideal for a wide variety of presentation applications and sources including HDTV and video viewing, teleconferencing, design reviews, work-group collaboration, executive meetings, events and tradeshows. Panther Plus adds stereo audio capability for a complete presentation solution.

Outstanding image quality

The Panther digital displays use Clarity's Advanced Performance Liquid Crystal Display (AP/LCD™) technology to deliver the highest image quality and highest available resolution (1,600 x 1,200) among presentation systems. They also feature a 1,200:1 contrast ratio—three to five times better than other systems—for the presentation of detailed, graphics-intensive information in corporate environments.

Compact size and easy mobility

The digital display is encased in a sleek, attractive cabinet that is just 26.5 inches deep to occupy minimal floor space. Its built-in casters allow easy movement between boardrooms, design centers, conference rooms and meeting areas.

Input from any source

Panther has a unique image processing capability that scales and optimizes a variety of inputs, from VGA to UXGA computer formats, and HDTV. The system has a convenient side-panel input for connection to a laptop computer, and provides RS-232 and IR remote control for easy set-up and operation.

Fast access to components

Easily accessible rear service panels allow technicians, installers and engineers to access electronics and optics modules in minutes.

clarity[®]
visual systems

Panther UXP

Views

Front

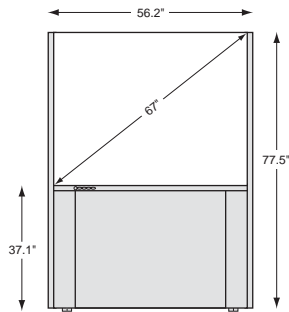

Side

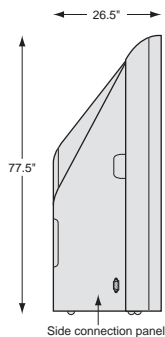

Side connection panel

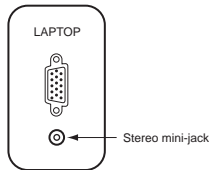

Audio panel

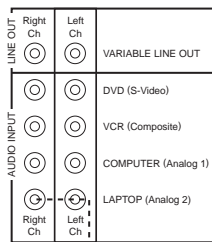

Internally cabled to side connection panel for laptop input

Connection panel

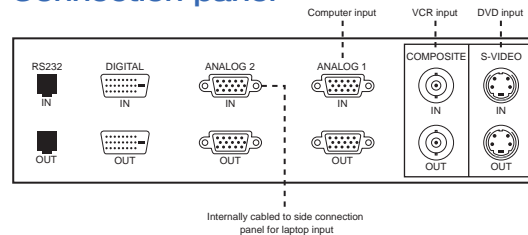

Front panel

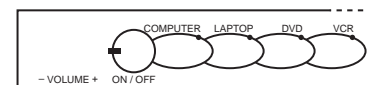

Panther UXP (PN-6730-UXP–PN-6740-UXP)

Display resolution	1,600 x 1,200 (UXGA)	
Aspect ratio (W:H)	4:3	
Screen dimensions*		
Diagonal	67" (170 cm)	
Width by height	53.3" x 40.0" (135 cm x 102 cm)	
Cabinet dimensions* (WxHxD)	56.2" x 77.5" x 26.5" (143cm x 197cm x 67.2cm)	
Screen type	High-Contrast black glass screen (high ambient light rejection)	
On-axis gain	1.7	
Viewing angle (hor.,vertical) 1/5 gain	90°/90°	
Screen brightness		
Two lamps	175 cd/m2	51 fL
One lamp	87 cd/m2	26 fL
Quality Viewing Metric (QVM)**		
With two lamps	12,600	
QVM @ 50° viewing angle	500	
Contrast ratio (full field)	>1,200:1 typical	
Weight	~410 lbs (186 kg)	
Lamp life (median)	6,000 hours	
Lamp type	200-watt High Pressure Mercury Discharge Lamps (x2)	
Line voltage	100-200V, 200-240V@50/60Hz	
Power consumption (two lamps)	690 watts	
Serviceability	Access from rear	
Rear ventilation required	8"	
Colors	16.7 million	
Operating temperature	32-95° F (0-35° C)	
Operating humidity	20-80% non-condensing	
Safety regulations	Complies with UL, cUL, FCC Class A, CISPR22/85, TUV/GS, CE	
Display technology	AP/LCD rear projection	
Data input		
Analog	VGA to UXGA@60Hz; Two 15-pin HD D-sub connectors	
Digital	DVI-D connector	
Video input	Composite video (NTSC, PAL) on BNC and S-Video connector High Definition (720p, 1080i) RGBHV on 15-pin HD D-sub connectors	
Audio input (PN-6740-UXP only)	One stereo input (RCA connectors) for each of two computer inputs and two video inputs. Switched variable line output. 10W internal stereo audio.	
Display control	RS232 and IR remote	

*Weight and dimensions are approximate. Specifications and design are subject to change without notice. This product may be subject to export control regulations.

** QVM, Quality Viewing Metric, is a calculation that employs the key imaging components of brightness, contrast ratio, and screen reflectance to determine the overall 'viewability' of a given imaging device. Clarity's research has determined that QVM is a more meaningful metric for evaluating image quality performance than any of these components alone. See our technology notes on image quality at www.clarityvisual.com/technotes.

Clarity Visual Systems is a registered trademark of Clarity Visual Systems, Inc. AP/LCD and the AP/LCD logo are trademarks of Clarity Visual Systems, Inc.

Copyright © 2002 Clarity Visual Systems, Inc. All rights reserved. This document may not be copied in any form without written permission from Clarity Visual Systems, Inc. Information in this document is subject to change without notice.

Clarity Visual Systems, Incorporated

9025 S.W. Hillman Court, Suite 3122
Wilsonville, Oregon, 97070, USA
Phone: 503-570-0700
Fax: 503-682-9441
<http://www.clarityvisual.com>

